



University of Michigan

2023-2024 Returning Resident Housing Application for West Quad 6 Person Suite

In order to be considered for this housing option, the following conditions must be met:

1. All students must be eligible to participate in Returning Resident Housing (review “Who is Eligible to Participate” on the Housing website: <https://housing.umich.edu/returning-resident-housing/>).
2. All rooms must be filled.
3. This form (including signatures from each student and the statement noted above) must be submitted to the Housing Information Office no later than **12:00 PM (Noon) on January 18, 2023**. The Housing Information Office is located in the Student Activities Building, room 1011. We encourage actual paper submission to ensure there are no technological glitches in our receipt of your application.
4. Application groups can be mixed gender.

Contract offers will be sent as early as January 20, 2023 and continue on a rolling basis until the suites are full.

Please check your email frequently. If your group is offered a suite, everyone in the group must submit their contract within 24 hours; if there are any outstanding contracts for any group members, the assignment for the group will be rescinded and offered to another group.

If you have any questions about this application contact Michigan Housing at housing@umich.edu.

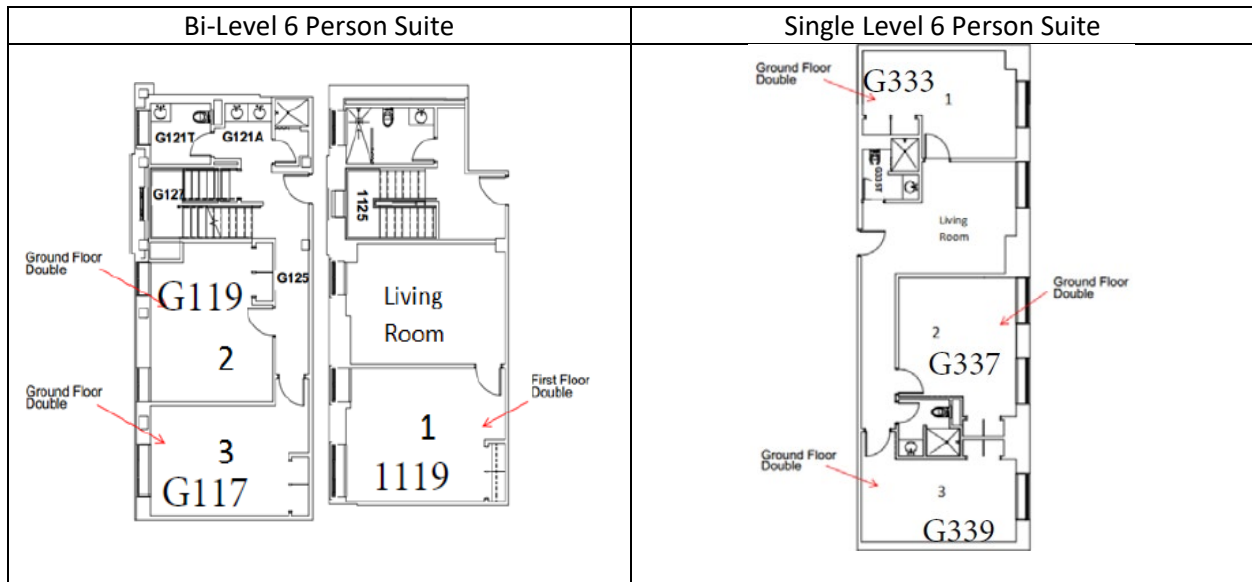

Continued on next page

Please rank your group's suite floor plan preference below.

Floor Plan	Rank
Bi-Level 6 Person Suite	
Single Level 6 Person Suite	

Indicate the room each person will be living in if accepted into one of the 6 Person Suites in West Quad.

Room 1: Double (2 Person) Room (Rate Type = RH-3)

Roommate 1 Name: _____ UMID: _____

Roommate 1 Signature: _____ Date: _____

Roommate 2 Name: _____ UMID: _____

Roommate 2 Signature: _____ Date: _____

Room 2: Double (2 Person) Room (Rate Type = RH-3)

Roommate 1 Name: _____ UMID: _____

Roommate 1 Signature: _____ Date: _____

Roommate 2 Name: _____ UMID: _____

Roommate 2 Signature: _____ Date: _____

Room 3: Double (2 Person) Room (Rate Type = RH-3)

Roommate 1 Name: _____ UMID: _____

Roommate 1 Signature: _____ Date: _____

Roommate 2 Name: _____ UMID: _____

Roommate 2 Signature: _____ Date: _____

Submission of this application does not guarantee a space in Michigan Housing.