



## University of Michigan

### 2020 – 2021 Returning Resident Housing Application for West Quad 6 Person Suite

In order to be considered for this housing option, the following conditions must be met:

1. All students must be eligible to participate in Returning Resident Housing (review “Who is Eligible to Participate” on the Housing website: <https://housing.umich.edu/returning-resident-housing/>).
2. All rooms must be filled.
3. This form (including signatures from each student and the statement noted above) must be submitted to the Housing Information Office no later than **12:00 pm (Noon) on January 22, 2020**. The Housing Information Office is located in the Student Activities Building, room 1011. We encourage actual paper submission to ensure there are no technological glitches in our receipt of your application.
4. Applicant groups can be mixed gender but must be single gender within a given room (i.e., a male and female cannot share a double room).

All applicants will be notified by email on January 24, 2020 (most likely after 12:00 pm Noon).

Please check your email frequently. If your group is offered a suite, everyone in the group must submit their contract within 24 hours; if there are any outstanding contracts for any group members, the assignment for the group will be rescinded and offered to another group. The group will be contacted by the Hall Director after contracts have been submitted to discuss what the group may be able to contribute to the community.

If you have questions about this application contact University Housing at [housing@umich.edu](mailto:housing@umich.edu).

Note there are THREE suites, each with a unique floor plan:

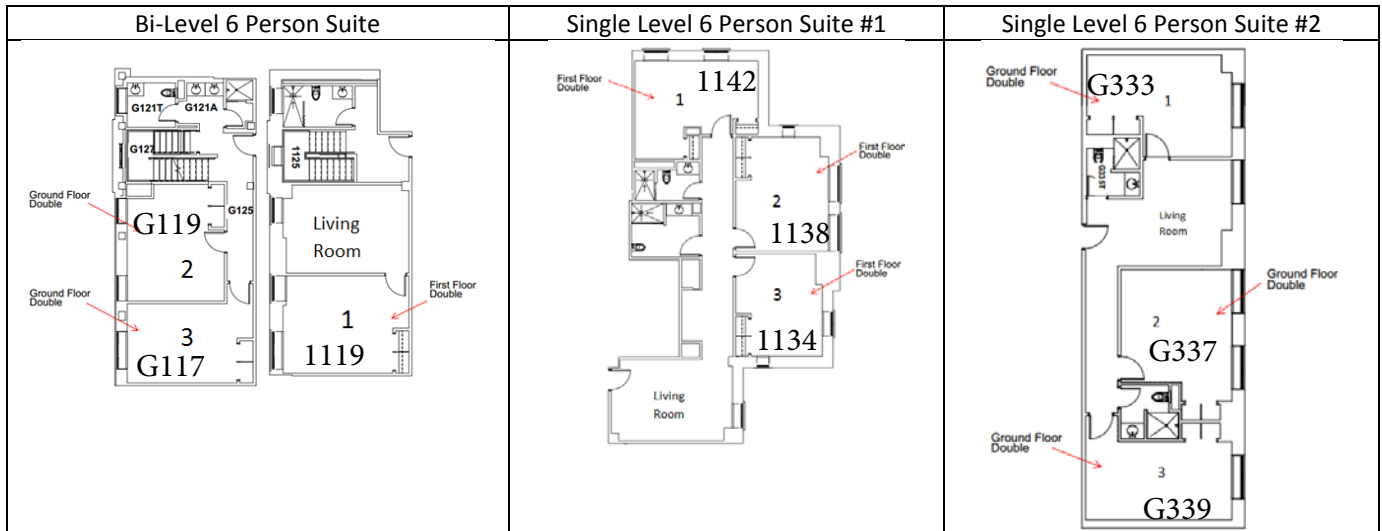

Continued on next page

Provide your group's suite floor plan preference: rank order (with 1 as your group's top choice, 2 as your second choice, etc)

Floor Plan	Rank
Bi-Level 6 Person Suite	
Single Level 6 Person Suite #1	
Single Level 6 Person Suite #2	

Indicate the room each person will be living in if accepted into one of the 6 Person Suites in West Quad.

**Room 1: Double (Rate Type = RH-3)**

Student Name: \_\_\_\_\_ UMID: \_\_\_\_\_

Signature: \_\_\_\_\_ Uniqname: \_\_\_\_\_

Student Name: \_\_\_\_\_ UMID: \_\_\_\_\_

Signature: \_\_\_\_\_ Uniqname: \_\_\_\_\_

**Room 2: Double (Rate Type = RH-3)**

Roommate 1 Name: \_\_\_\_\_ UMID: \_\_\_\_\_

Signature: \_\_\_\_\_ Uniqname: \_\_\_\_\_

Roommate 2 Name: \_\_\_\_\_ UMID: \_\_\_\_\_

Signature: \_\_\_\_\_ Uniqname: \_\_\_\_\_

**Room 3: Double (Rate Type = RH-3)**

Roommate 1 Name: \_\_\_\_\_ UMID: \_\_\_\_\_

Signature: \_\_\_\_\_ Uniqname: \_\_\_\_\_

Roommate 2 Name: \_\_\_\_\_ UMID: \_\_\_\_\_

Signature: \_\_\_\_\_ Uniqname: \_\_\_\_\_